

REV D 1060-12-02**		REVISIONS		
SYM	DESCRIPTION	DATE	APPROVED	
A	REVISED PER E.O. P17489	11-2-01	R.D.R.	
B	REVISED PER E.O. P17675	3-15-02	R.D.R.	
C	REVISED PER E.O. P18856	3-15-05	R.D.R.	
D	REVISED PER E.O. P19555	7-11-07	RDR	

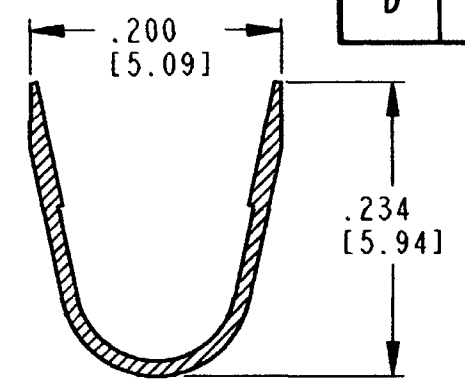

**SECTION A-A**  
CONDUCTOR WINGS

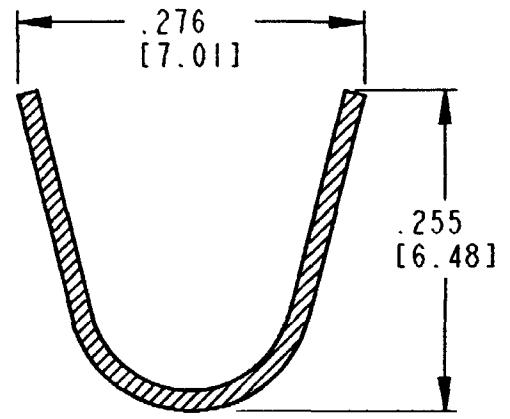

**SECTION B-B**  
INSULATION WINGS

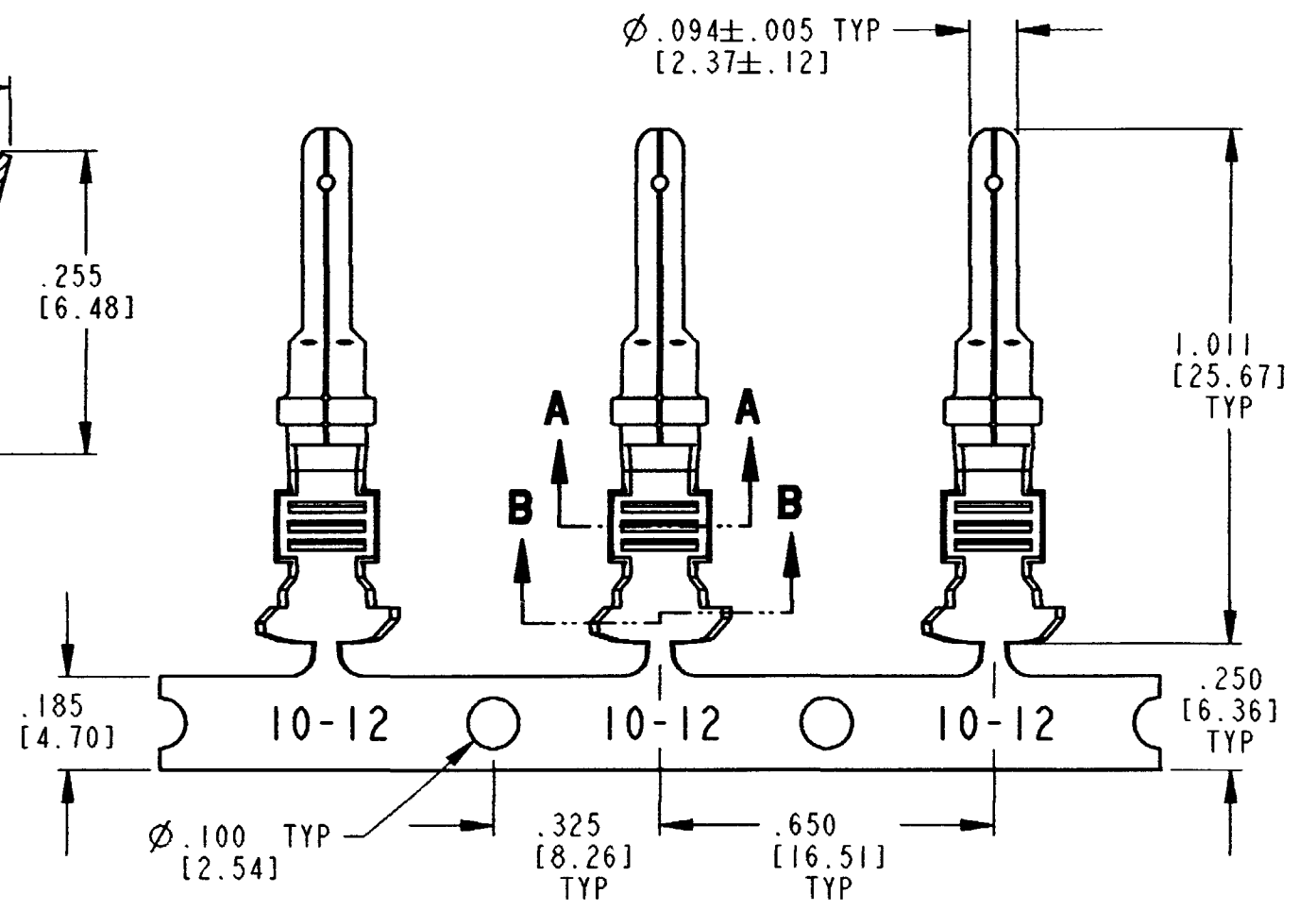

7. CONTACT MATERIAL CONTAINS 98% COPPER MINIMUM.
  6. WHEN \*\* = 22 PLATING IS NICKEL.  
\*\* = 44 PLATING IS GOLD.
  5. SEE 0425-015-0000 FOR CONTACT PERFORMANCE AND WIRE APPLICATION CHARACTERISTICS.
  4. THIS CONTACT MAY BE CRIMPED WITH DCT12-02-01 AUTOMATIC DIE OR DTT-12-01 HAND TOOL. SEE DRAWING 0425-041-0000 FOR APPLICABLE WIRE SIZE, INSULATION DIAMETER RANGE, AND CRIMPING INFORMATION.
  3. ONE REEL CONTAINS APPROXIMATELY 2000 CONTACTS.
  2. DIMENSION TOLERANCE: ±.025 [ .64].
  1. DIMENSIONS ARE IN INCHES [mm].
- NOTES: UNLESS OTHERWISE SPECIFIED

SIGNATURE & DATE		STAMPED CONTACT PIN SIZE 12	EP EPI01	MATL-CODE
DR	D. MEYER 03/08/01		The Deutsch Company DEUTSCH I.P.D. 3850 INDUSTRIAL AVE. HEMET, CALIF. 92545	
CHK	<i>[Signature]</i> 7/11/07		<b>B</b> 1060-12-02**	
PE	<i>[Signature]</i> 7/10/07			
APPD	<i>[Signature]</i> 7-11-07	ENVELOPE	DWG SIZE	CODE 11139
SCALE	NONE	WT	SHEET   OF	