

DRAWING MADE IN THIRD ANGLE PROJECTION

LOC DIST

© Copyright 1979 by AMP DO BRASIL - S. P. All International Rights Reserved. AMP Incorporated products covered by U. S. and Foreign patents and/or patents pending.

REVISIONS			
LTP	DESCRIPTION	DATE	APPROVED
A	ERA P79-29157	17/6/80	[Signature]
B	ACRESCENTADO TRAÇOS 3 e 4	16.6.82	[Signature]
C	REVISADO	22.8.83	[Signature]
D	REVISADO	13-8-84	[Signature]
E	DEG. REVISADO	24-8-88	[Signature]
F	INATIVADO OS TRAÇOS 3 e 4	08/Mar/90	DORI [Signature]
G	REVISADO ECN 3376	28-Apr-93	Dori [Signature]

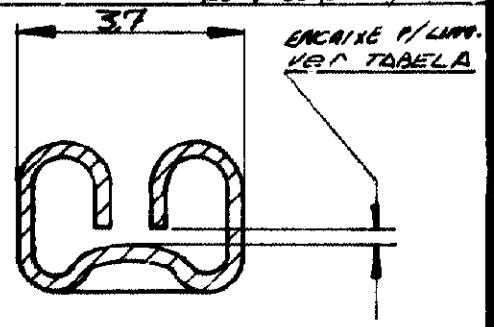
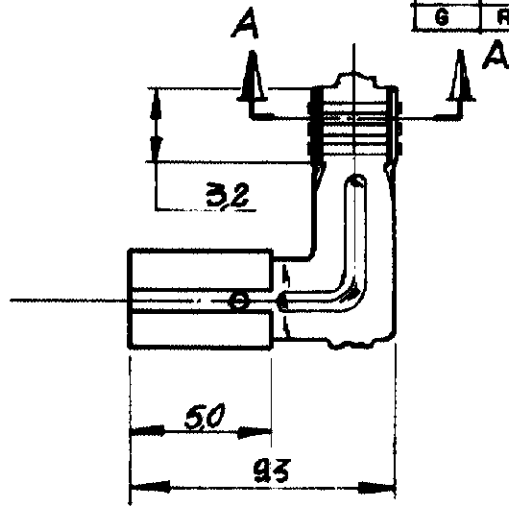

SECCÃO B-B ESC. 8:1

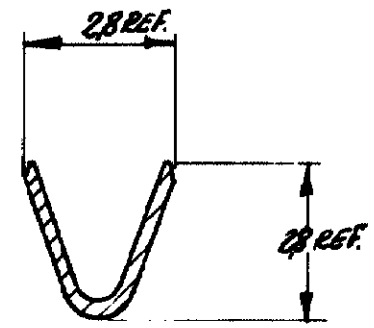
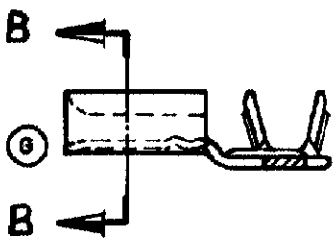

SECCÃO A-A ESC. 8:1

(F) INACTIVE	0.5mm	ESTANHADO	LATÃO	626481-4
(F) INACTIVE	0.5mm	---	LATÃO	626481-5
	0.8mm	ESTANHADO	LATÃO	626481-2
	0.8mm	---	LATÃO	626481-1
	esp. do LINGU.	ACABAMENTO	MATERIAL	PART NO

UNLESS OTHERWISE SPECIFIED DIMENSIONS ARE IN mm. TOLERANCES ON: DECIMALS ± ANGLES ±

MATERIAL  
**VER TABELA**

FINISH  
**VER TABELA**

CONTRACT NO  
DR *U. N. ROCHA 12/12/79*  
CHK  
APPD  
APPD  
WIDE-RANGE  
0.5 - 1.3 mm<sup>2</sup>  
OTHER APPD

TOLERANCE

**AMP** AMP DO BRASIL  
S. Paulo - Brasil

NAME  
**.110 SERIES FLAG FASTON RECEPT.**

SIZE LOC AP. DRAWING NO  
**A** **626481**

SCALE 4:1 SHEET 1-1 OF F

CUSTOMER DRAWING